

Linear potentiometers Internal spring return, Slim body series

- + Measuring range 10 - 50 mm
- + Long mechanical life
- + Excellent repeatability <0.01 mm
- + Infinite resolution



MSLPIS

Technical specifications

Measurement stroke	10 to 50 mm
Linearity	± %0,05
Repeatability	< 0,01 mm
Resolution	Infinite
Resistance	2 KOhm
Resistance tolerance	± %20
Recommended cursor current	<1 µA
Electrical connections	Cable 1m
Displacement speed	< 5 m/s
Mechanical life	100 million cycles
Case dimensions	Ø18 mm
Case material	Anodized aluminium
Rod material	Stainless steel
Rod diameter	Ø5 mm
Mechanical fixing	Variable brackets
IP degree	IP 65
Operating temperature	-20°C ... +80°C
Storage temperature	-30°C ... +90°C

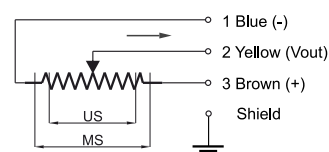
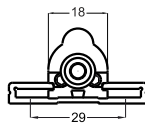
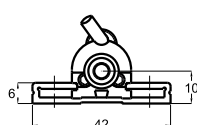
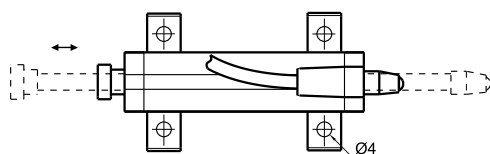
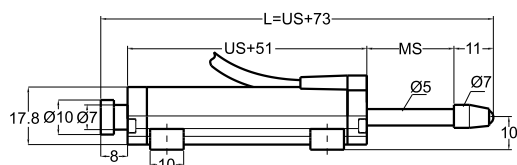

SLPIS (mm)	10	25	50
US (Usefull Stroke)	10	25	50
MS (Mechanical Stroke)	14	29	54
L (Total Length)	83	98	123

Model	Measurement stroke (mm)	Linearity (%)	Resistance (KOhm)	Connector / Cable
(example) SLPIS	25	D	5K	1M
SLPIS	10 ... 50mm	D : ± %0,05 (standard)	2K : 2 KOhm (10-25mm) 5K : 5 KOhm 10K : 10 KOhm	1M : 1 meter cable 1M5 : 1,5 meter cable