

- Measuring range 10 – 100mm
- For tight area applications
- <0.01mm repeatability
- Infinite resolution
- 2 kOhm : 10 – 50 mm
- 5 kOhm : 75 – 100mm

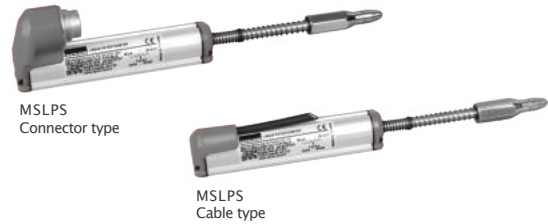

### Technical Specifications

Measurement stroke	10 – 100 mm
Linearity	±%0.5 (≤75 mm), ±%0.2 (100 mm)
Repeatability	<0.01 mm
Resolution	Infinite
Resistance	2 kOhm : 10 – 50 mm 5 kOhm : 75 – 100 mm
Resistance tolerance	±%20
Load resistance	100kOhm min.
Recommended wiper current	<1µA
Permissible applied voltage	28VDC max.
Electrical connections	Connector or 1 m cable output
Displacement speed	<5 m/s
Mechanical life	>100million movement
Case dimensions	Ø18 mm
Case material	Anodizedaluminium
Rod material	Stainless steel
Rod diameter	Ø5 mm
Mechanical fixing	Variable brackets
Protection level	IP 40
Operating temperature	-20°C... +80°C
Storage temperature	-30°C... +90°C

### Mechanical Specifications

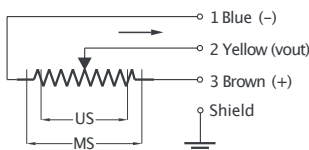
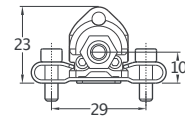
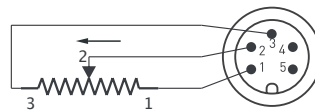
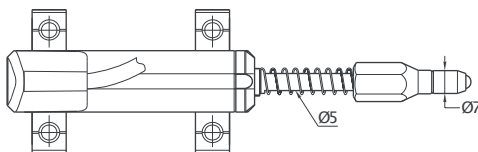
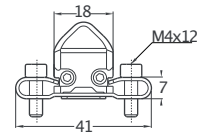
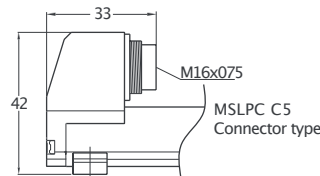
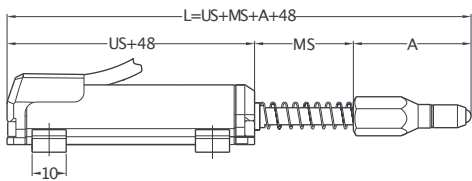

MSLPS (mm)	10	25	50	75	100
US (Usefull stroke)	10	25	50	75	100
MS (Mechanical stroke)	13	28	53	78	103
L (Total length)	106	134	193	243	293

A	
MSLPS	35
MSLPS 25	35
MSLPS 50	42
MSLPS 75	42
MSLPS 100	42

### Ordering Procedure

Model	Measurement stroke (mm)	Linearity (%)	Resistance (kOhm)	Connector /Cable
MSLPS	75	A	5K	CN5B
MSLPS	10 – 100 mm	A: ±%0.5 (≤75 mm), B: ±%0.2 (100 mm)	2K : 2 kOhm (<75mm) 5K : 5 kOhm (75–100mm)	1M : 1 meter cable 1M5 : 1,5 meter cable 2M : 2 meter cable CN5B: M16, 5 pin connector