

PRESSURE TRANSMITTER

ATM.1ST
ATM.1ST/Ex



 II 1G Ex ia IIB/IIC T3...T6
II 1D Ex iaD 20 IP6x T145...T70°C

Features

- Compact and robust stainless steel assembly 1.4435 or titanium
- Piezoresistive measuring element
- Measuring ranges from 0...50mbar to 0...1000bar
- Calibration available for all common pressure units
- Reverse polarity and short circuit protected
- High EMV stability
- Customized versions due to modular assembly

Typical applications

- Machine installations
- Environmental monitoring
- Food industry
- Mobile hydraulics
- Test and calibration systems

Ordering information

		ATM.1ST	ATM.1ST/Ex	X	. XXXX	. XXXX	. XX	. XXX
Type	ATM.1ST							
	ATM.1ST/Ex							
Pressure type	Gauge			1				
	Absolute (vacuum)			2				
	Sealed gauge			3				
Pressure range	Any pressure ranges between 0...100mbar and 1000bar available ¹¹⁾				XX			
Pressure connection	G 1/4 I	(Fig. 1)				00		
	G 1/4 A	(Fig. 2)				11		
	G 1/2 A	(Fig. 3)				13		
	G 1/2 A, frontal diaphragm	(Fig. 4)				14		
	G 1/2 A, flush diaphragm	(Fig. 5)				15		
	1/4 NPT A	(Fig. 6)				10		
	1/2 NPT A	(Fig. 7)				19		
	Special connections available					XX		
Electrical connection	Connector DIN 43650 (screwed on) ¹⁾	(Fig. 8)	IP 65				01	
	Connector Binder 723, 5-pin ¹⁾	(Fig. 9)	IP 67				03	
	Connector Binder 723, 5-pin (screwed on) ¹⁾	(Fig. 10)	IP 67				43	
	Connector MIL C26482, (10-6) ¹⁾	(Fig. 11)	IP 40				06	
	PE cable ^{2) 4)}	(Fig. 12)	IP 67				13	
	PUR cable ^{2) 3)}	(Fig. 12)	IP 67				15	
	Teflon cable ²⁾	(Fig. 12)	IP 67				21	
	PUR cable, blue ^{2) 3) 5)}	(Fig. 12)	IP 67				17	
	Teflon cable, blue ^{2) 5)}	(Fig. 12)	IP 67				22	
	Special connections available						XX	
Output signal	4...20 mA						05	
	0...5V (no Ex-version)						46	
	0...10V (no Ex-version)						47	
Accuracy	≤ ± 0.25% FS						1	
	≤ ± 0.1% FS (≤ 600 bar FS)						2	
	≤ ± 0.05% FS (≥ 500 mbar ... ≤ 100 bar FS)						6	
Temperature range ⁷⁾	0...70°C compensated (allowed medium temperature -40...125°C)						0	
	-25...100°C compensated (allowed medium temperature -40...125°C)						1	
	-25...100°C compensated (allowed medium temperature -40...150°C)						2	
	-40...100°C compensated (allowed medium temperature -40...125°C)						3	
	-40...125°C compensated (allowed medium temperature -40...125°C) ⁶⁾						4	
Temperature class ⁸⁾	T6 (Ta: -40...50°C) 0...70°C compensated (allowed medium temperature -40...50°C)						0	
(Ex version)	T4 (Ta: -40...85°C) -25...100°C compensated (allowed medium temperature -40...110°C)						1	
	T3 (Ta: -40...125°C) -25...100°C compensated (allowed medium temperature -40...150°C)						2	
	T3 (Ta: -40...125°C) -40...100°C compensated (allowed medium temperature -40...125°C)						6	
Options	Throttle ⁹⁾							A
	Special oil filling in the TD: ASEOL Food							G
	Halocarbon (for oxygen applications) ¹⁰⁾							H
	Seals: Viton (standard)							U
	EPDM							S
	Kalrez							T
	Version titanium							K
	Active compensated							E
	Aging (burn-in)							Z

¹⁾ Cable socket connector not included

²⁾ Please specify the required cable length

³⁾ For medium temperature > 50°C a PE or teflon cable must be used

⁴⁾ Food approved

⁵⁾ Cable types for ATM.1ST/Ex

⁶⁾ With option E: Active compensated

⁷⁾ Temperature range for ATM.1ST

⁸⁾ Temperature class for ATM.1ST/Ex

⁹⁾ Only with pressure connection Fig. 2 and Fig. 3

¹⁰⁾ Max. pressure range ... 120 bar (burst pressure > 175 bar)

¹¹⁾ 0...50mbar on request

Pressure connections

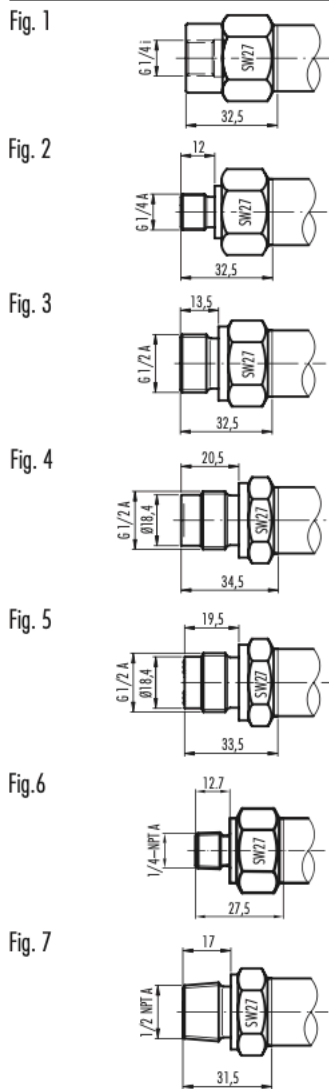

Dimensions

Version for medium temperature up to 125°C

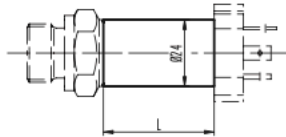

L = 25 mm for connector DIN 43650

Version for medium temperature >125°C up to 150°C

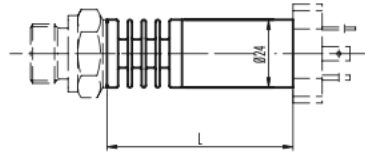

L = 52 mm for connector DIN 43650

Electrical Connections

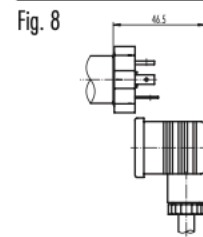

Pin	2-wire	3-wire
1	+Vin	+Vin
2	Pout	Pout
3	PROG2	GND
E	PROG1	PROG1
E	EP (only Ex)	

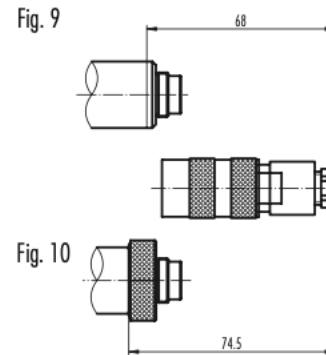

Cable socket connector

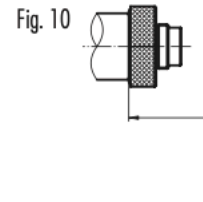

Pin	2-wire	3-wire
1	Pout	Pout
2	PROG1	PROG1
3	+Vin	+Vin
4	PROG2	GND
5	EP (only Ex)	

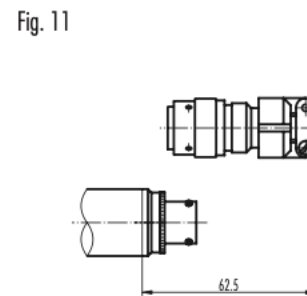

Cable socket connector



Pin	2-wire	3-wire
A	+Vin	+Vin
B	PROG2	GND
C	Pout	Pout
D	PROG1	PROG1
E	EP (only Ex)	

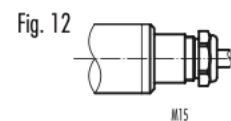

Colour	2-wire	3-wire
white	+Vin	+Vin
yellow	Pout	GND
brown		Pout
grey	EP (only Ex)	

SCAIME
L'INFINIMENT PRECIS INFINITE PRECISION

BP501 - F 74105 Annemasse Cedex
Tél. : (+33) 4 50 87 78 64
Fax : (+33) 4 50 87 78 42
E.mail : info@scaime.com

Téléchargez tous nos documents sur :
Download all our documents in :
www.scaime.com

Agent

MEGATRON, s.r.o.
Mrščíkova 16, 100 00 Praha 10
T.: 274 780 972, info@megatron.cz
www.megatron.cz